

# 2013 JOINT ANNUAL FREIGHT MEETING



INSTITUTE FOR TRADE AND  
TRANSPORTATION STUDIES



## BUILDING PATHS TO PROSPERITY: THE ROLE OF REGIONAL CORRIDORS



**MARCH 11-14, 2013**

**THE BROWN HOTEL**

**LOUISVILLE, KENTUCKY**

## **Mid-America Freight Coalition**

The Mid-America Freight Coalition (MAFC) is a regional organization that cooperates in the planning, operation, preservation, and improvement of transportation infrastructure in the Midwest. The ten states of the AASHTO Mid-America Association of State Transportation Officials (MAASTO) share key interstate corridors, inland waterways, and the Great Lakes. The MAFC is funded by the National Center for Freight & Infrastructure Research & Education and the DOTs of the ten member states.

## **Institute for Trade and Transportation Studies**

Headquartered in New Orleans, Louisiana, The Institute for Trade and Transportation Studies provides research data and expert opinions to its Members concerning the effects of commercial freight movements on domestic and international activities, with reference to infrastructure and transportation needs, and safety implications. The ITTS members include the Arkansas State Highway and Transportation Department, the Florida Department of Transportation, the Georgia Department of Transportation, the Kentucky Transportation Cabinet, the Louisiana Department of Transportation and Development, the Mississippi Department of Transportation, the Virginia Department of Transportation, and the West Virginia Department of Transportation.

# 2013 JOINT ANNUAL FREIGHT MEETING



INSTITUTE FOR TRADE AND  
TRANSPORTATION STUDIES

## TABLE OF CONTENTS

<b>TABLE OF CONTENTS</b>	
<b>THE BROWN HOTEL</b>	<b>2</b>
<b>SCHEDULE AT-A-GLANCE</b>	<b>3</b>
<b>PLANNING COMMITTEE</b>	<b>4</b>
<b>PARTNER ORGANIZATIONS</b>	<b>4</b>
<b>PLATINUM SPONSORS</b>	<b>5</b>
<b>GOLD SPONSORS</b>	<b>6</b>
<b>SILVER SPONSORS</b>	<b>6</b>
<b>SPEAKER BIOGRAPHIES</b>	<b>7</b>
<b>MONDAY, MARCH 11</b>	<b>20</b>
<b>TUESDAY, MARCH 12</b>	<b>22</b>
<b>WEDNESDAY, MARCH 13</b>	<b>26</b>
<b>THURSDAY, MARCH 14</b>	<b>37</b>
<b>CONFERENCE ATTENDEES</b>	<b>41</b>

FIRST FLOOR

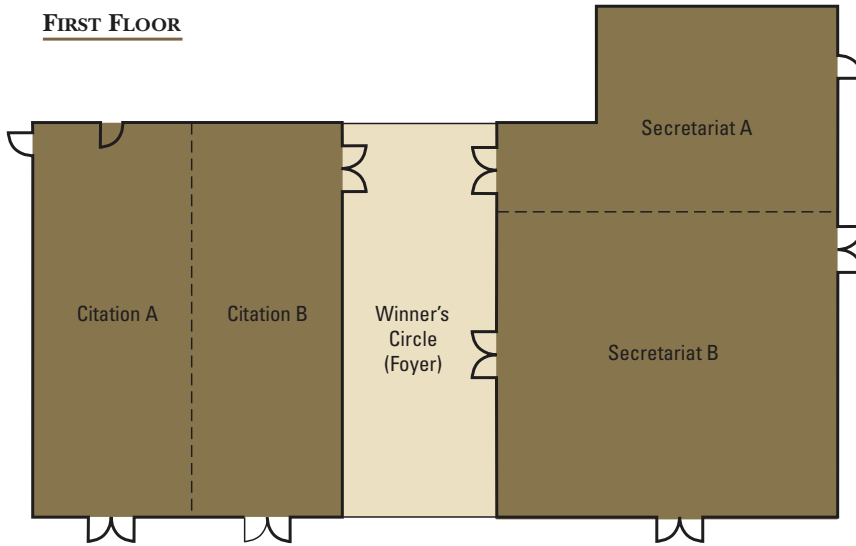

SECOND FLOOR



SIXTEENTH FLOOR

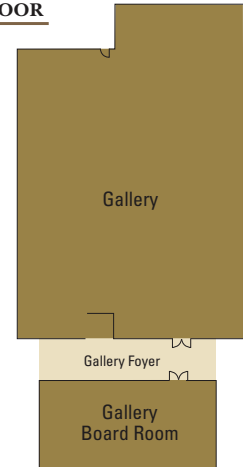

THIRD FLOOR

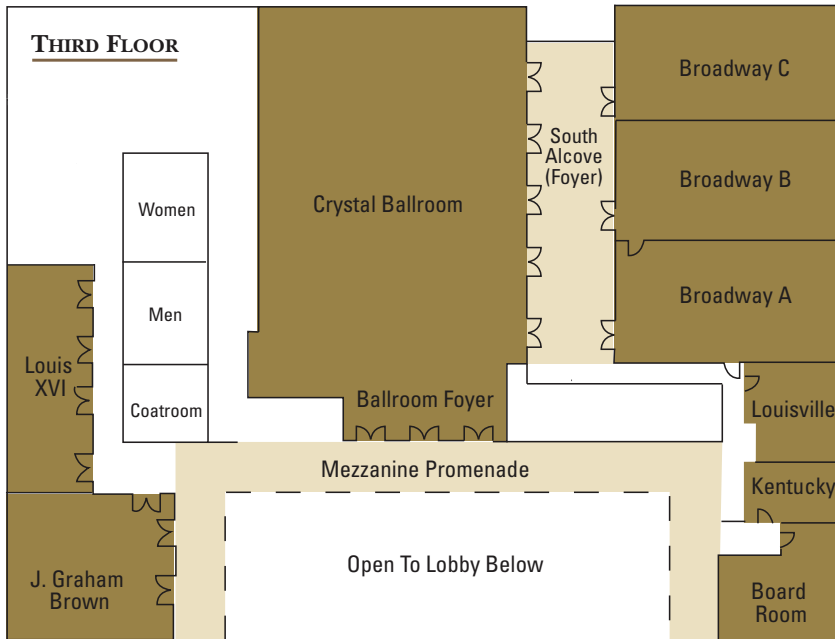

# 2013 JOINT ANNUAL FREIGHT MEETING



INSTITUTE FOR TRADE AND  
TRANSPORTATION STUDIES

## SCHEDULE AT-A-GLANCE

### Monday, March 11

2:00-6:00PM	BROADWAY A	STATE & MPO WORKSHOP: FREIGHT PLANNING AND PERFORMANCE METRICS
6:30-8:30PM	J. GRAHAM BROWN	STATE & MPO NETWORKING DINNER

### Tuesday, March 12

8:00AM-12:00PM	OFFSITE	TOURS OF FREIGHT FACILITIES
12:00-1:00PM	BLUEGRASS	LUNCH FOR TOUR ATTENDEES
1:00-2:00PM	CRYSTAL	OPENING AND WELCOMING REMARKS
2:00-3:30PM	CRYSTAL	PATHS TO PROSPERITY: WHY FREIGHT CORRIDORS
3:30-4:00PM	CRYSTAL	BREAK
4:00-5:30PM	CRYSTAL	THE ECONOMIC OUTLOOK: GLOBAL DIRECTIONS AND IMPLICATIONS FOR TRANSPORTATION
6:00-8:00PM	BLUEGRASS	RECEPTION (OPEN TO ALL ATTENDEES)

### Wednesday, March 13

7:00-8:00AM	BLUEGRASS	BREAKFAST
8:00-9:30AM	CRYSTAL	MAP-21 AND THE WASHINGTON PERSPECTIVE
9:30-10:00AM	SOUTH ALCOVE	BREAK
10:00-11:30AM	CRYSTAL	INTEGRATING STATE, REGIONAL, LOCAL, AND PRIVATE SECTOR FREIGHT PLANNING
11:45AM-1:00PM	BLUEGRASS	LUNCHEON & KEYNOTE ADDRESS
1:00-2:30PM		BREAKOUT SESSIONS
	BROADWAY A	<i>Agricultural Trade: Biofuels and Exports</i>
	BROADWAY B	<i>Freight Corridors: Collaboration, Development, and Impacts</i>
	BROADWAY C	<i>Getting Goods to Local Markets and Creating Supply Chains that Work</i>
2:30-3:00PM	SOUTH ALCOVE	BREAK
3:00-4:30PM		BREAKOUT SESSIONS
	BROADWAY A	<i>Trends in Warehousing and Site Development: Business Clusters and Co-Location</i>
	BROADWAY B	<i>Designing for Freight: Corridor Development</i>
	BROADWAY C	<i>From the Trucking Industry: What Agencies Should Know About Policy, Operations, and the Future</i>
10:15-11:15PM	CITATION A	LATE NIGHT COFFEE AND TEA RECEPTION AND TOUR CHECK-IN
11:30PM-1:30AM	OFFSITE	UPS TOUR

### Thursday, March 14

7:00-8:00AM	BLUEGRASS	BREAKFAST
8:00-9:30AM	CRYSTAL	UNDERSTANDING THE AUTOMOTIVE INDUSTRY AND THE ROLE OF TRANSPORTATION
9:30-10:30AM	CRYSTAL	FROM UNDERSTANDING TO ACTION: MAKING FREIGHT CORRIDORS WORK FOR OUR ECONOMY
10:30-11:00AM	SOUTH ALCOVE	BREAK
11:00AM-12:00PM	BROADWAY A	ITTS PARTNER SESSION: RESEARCH AND REGIONAL NEEDS
	BROADWAY B	MAFC PARTNER SESSION: RESEARCH AND REGIONAL NEEDS
12:00PM		ADJOURN





# 2013 JOINT ANNUAL FREIGHT MEETING



## PLANNING COMMITTEE

The 2013 Joint Annual Freight Meeting is the result of a collaboration between the Mid-America Freight Coalition, the Institute for Trade and Transportation Studies, and the Kentucky Transportation Cabinet. The conference planning committee consists of the following people:

**Teresa Adams**  
*National Center for Freight & Infrastructure Research & Education*

**Cheryl Ball**  
*Missouri Department of Transportation*

**Ernie Perry**  
*Mid-America Freight Coalition*

**Lynn Soporowski**  
*Kentucky Transportation Cabinet*

**Bruce Lambert**  
*Institute for Trade and Transportation Studies*

**Jeremy Edgeworth**  
*Kentucky Transportation Cabinet (formerly)*

**Lori Kelsey**  
*Kentuckiana Regional Planning & Development Agency*

**Keith Bucklew**  
*CDM Smith (formerly of InDOT)*

**Randall Embry**  
*Kentuckiana Regional Planning & Development Agency*

**Bernadette Dupont**  
*Federal Highway Administration, Kentucky Division*

The planning committee would like to thank the CFIRE staff members for the work that made this conference possible: Lisa Beneker, Maria Hart, Alex Marach, Steve Wagner, and Ben Zietlow.

## PARTNER ORGANIZATIONS

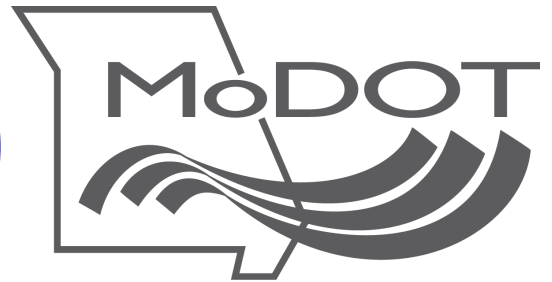

# 2013 JOINT ANNUAL FREIGHT MEETING



## PLATINUM SPONSORS



INSTITUTE FOR TRADE AND  
TRANSPORTATION STUDIES



# Economic Development

---

# RESEARCH GROUP



# 2013 JOINT ANNUAL FREIGHT MEETING



**GOLD SPONSORS**

# CDM Smith

listen. think. deliver.

**SILVER SPONSORS**





# 2013 JOINT ANNUAL FREIGHT MEETING



INSTITUTE FOR TRADE AND  
TRANSPORTATION STUDIES

## SPEAKER BIOGRAPHIES

### **TERESA ADAMS**

*University of Wisconsin-Madison*

Teresa Adams is Professor of Transportation Engineering and City Planning in the Department of Civil and Environmental Engineering at the University of Wisconsin–Madison, as well as director of the National Center for Freight and Infrastructure Research and Education. She is also principal investigator for the Mid-America Freight Coalition. Adams is a member of the board of directors for the American Road and Transportation Builders Association, Research and Education Division, the American Transportation Research Institute's Research Advisory Committee, and a member of the Committee on Intermodal Freight Transport for the Transportation Research Board. She is also chair of the Transportation Management and Policy graduate certificate program and a faculty affiliate of the Gaylord Nelson Institute for Environmental Studies. Adams holds a PhD and MS in civil engineering from Carnegie Mellon University and a BS in civil engineering from the University of Pittsburgh.

### **ROBYN BANCROFT**

*Ohio-Kentucky-Indiana Regional Council of Governments*

Robyn Bancroft serves as Strategic Projects Manager for the Ohio-Kentucky-Indiana Regional Council of Governments (OKI), where she guides the agency's regional transportation plan updates, freight planning activities, and special-topic transportation studies. Prior to beginning work at OKI in October 2004, Bancroft served as Director of The AMOS Project, a Greater Cincinnati social justice, not-for-profit. She moved to Cincinnati in 2000 from Rockford, Illinois where she had served as the city's first Neighborhood Planner. Her first professional planning position was with the Greater Bridgeport Regional Planning Agency in Connecticut. Bancroft holds a masters degree in urban and regional planning from the University of Illinois at Champaign-Urbana and a bachelor of arts degree in the history and criticism of art from Florida State University.

### **MARK BERNDT**

*Olsson Associates*

Mark J. Berndt is the Freight Planning Program Leader for Olsson Associates. He has 32 years of professional experience related to freight transportation and economic development planning. Berndt spent 20 years with the State of Minnesota, working for the Minnesota Department of Energy and Economic Development and the Minnesota Department of Transportation (MnDOT). For the past 12 years he has worked as a consultant helping both public and private sector clients support business needs through transportation across the United States. He has worked on goods movement policy studies for statewide and corridor plans in more than 25 states. He has also conducted number of regional freight studies. He has also contributed to business and trade group policy studies for organizations such as: The National Cotton Council, The Minnesota Chamber of Commerce and The Inland Pacific Hub (Eastern Washington). Berndt is currently Vice-chair of the Transportation Research Board (TRB) Agricultural Transportation Committee, and a member of the TRB Logistics of Humanitarian Aid Task Force. He is also a member and past chairman of the TRB Truck Size and Weight Committee and is a former member and current friend of The Intermodal Freight Transport Committee.

### **RICH BITER**

*Florida Department of Transportation*

Richard Biter is the Assistant Secretary of Intermodal Systems Development for the Florida Department of Transportation. He also serves as Vice-Chair of AASHTO's Special Committee on Intermodal Transportation and Economic Expansion. Biter served as a Principal of a Florida-based transportation consulting firm and was also a former Acting Associate Deputy Secretary and Director Office of Intermodalism at the US Department of Transportation. He brings with him over 30 years of transportation program and policy making experience in the private and federal government transportation sectors. Biter has a significant track record in creating federal intermodal transportation solutions for moving people and goods efficiently, boosting productivity and job growth, and strengthening our nation's competitiveness in the global



# 2013 JOINT ANNUAL FREIGHT MEETING



## SPEAKER BIOGRAPHIES, CONTINUED

economy through the more efficient use of our transportation resources. He holds a BS in transportation and economics from Trine University.

### **BRETT BOURGEOIS**

*New Orleans Board of Trade*

Brett Bourgeois is the Executive Director of the New Orleans Board of Trade, Ltd. (NOBOT), where he is responsible for the day to day operations of the NOBOT's Marine Exchange. Bourgeois has over 21 years of experience in the New Orleans maritime industry. He began his career as a boarding agent for Fillette Green Shipping Services. Following his tenure as an agent, he was employed by the New Orleans Steamship Association where he was responsible for representing the members' interests on regulations governing the maritime industry on both the federal and state levels. Bourgeois holds a BS in management from the University of New Orleans.

### **KEITH BUCKLEW**

*CDM Smith*

Keith Bucklew is the Freight Discipline Leader at CDM Smith, where he specializes in the development of freight mobility plans, rail plans, and multimodal freight solutions. From 2006 to 2013, Bucklew served as the Director of Freight Mobility at the Indiana Department of Transportation, where he developed Indiana's Multimodal Freight & Mobility Plan and was the project manager for the I-70 Dedicated Truck Lanes project across the four-state coalition. Bucklew has nearly 30 years of experience in freight and logistics, in both the private and public sectors. He also serves and has served on a number of TRB, NCFRP, and AASHTO committees, as well as Mid-America Freight Coalition and the National Center for Freight and Infrastructure Research and Education committees. Bucklew also served for 30 years in the US Army and retired as a Colonel. He is Adjunct Instructor of Transportation, Logistics, and Supply Chain Management for Vincennes University and IVY Tech Community College, and serves as a member of IVY Tech's Business Program Advisory Council. He is also a certified instructor of Freight Planning for the Federal Highway Administration's National Highway Institute (NHI). Bucklew holds a BS in business management and marketing and a MBA from the University of Wisconsin-Madison and is a graduate of the US Army War College.

### **MARK BURTON**

*University of Tennessee*

Mark Burton is a research associate professor in the department of economics at the University of Tennessee and Director of Transportation Economics at UT's Center for Transportation Research. His professional career has included both academic and consulting research in the area of transportation and telecommunication economics. Most recently, this research has focused on various aspects of rail-truck intermodal and public-sector planning. In addition to authoring a number of articles and monographs, Burton has provided testimony in proceedings before the Surface Transportation Board, a variety of state agencies and legislative committees, and the US Senate. Burton holds a PhD in economics from the University of Tennessee.

### **JIM BRUCE**

*United Parcel Service*

Jim Bruce is Public Affairs Manager for United Parcel Service, based in Washington, DC. He is a subject matter expert in fleet operations.

# 2013 JOINT ANNUAL FREIGHT MEETING



INSTITUTE FOR TRADE AND  
TRANSPORTATION STUDIES

## SPEAKER BIOGRAPHIES, CONTINUED

### **KEITH DAMRON**

*Kentucky Transportation Cabinet*

Keith Damron, PE is the Director of the Division of Highway Planning for the Kentucky Transportation Cabinet. He has worked for the Transportation Cabinet for 26 years in various positions in traffic, highway design, construction, and planning in both the Pikeville District and Central Office. Most recently, his leadership for early project scoping using a data needs analysis has allowed KYTC to receive the Nation's Top Planning Award from AASHTO, the "2011 President's Transportation Award of Excellence for Planning," and allowed KYTC to receive honorable Mention for the FHWA and FTA "2012 Transportation Planning Excellence Award." Damron holds a BS and a MS in civil engineering from the University of Kentucky.

### **DENNIS DECKER**

*Louisiana Department of Transportation and Development*

Dennis Decker is the Assistant Secretary of Multimodal Planning at the Louisiana Department of Transportation and Development (LDOTD). Prior to joining LDOTD he retired from Federal Highway Administration in March 2011 after over 31 years of service. His last assignment with FHWA was Team Leader of FHWA's National Review Team from June 2009 until March 2011, where he was responsible for ensuring accountability and transparency of fund expenditures relative to the American Recovery and Reinvestment Act of 2009 (ARRA). Prior to this assignment, he served as the Division Administrator in FHWA's Ohio Division and Assistant Division Administrator in the West Virginia Division. He has been recognized with a number of performance and special act awards and has received the US DOT Secretary's Team Award (2011), two Administrator's Superior Achievement Awards (1989 and 2000), the FHWA Innovation Award, the FHWA Strive For Excellence Award and AASHTO Trailblazer Award. Decker holds a bachelor's degree in civil engineering from the Georgia Institute of Technology.

### **PATRICK DONOVAN**

*Marshall University*

Patrick J. Donovan is Director for Maritime and Intermodal Transportation at the Rahall Transportation Institute and Director of the National Maritime Enhancement Institute, both at Marshall University. He is responsible for establishing, managing and implementing programs to facilitate the development of transportation facilities that support the Appalachian Region's integration into the global economy. He is a recognized Inland Navigation Leader and served as Vice President of the National Waterways Conference, Inc. He was also the Vice-Chairman of the American Association of State Highway and Transportation Officials Standing Committee on water transportation. He also serves as West Virginia's appointed representative on the Appalachian Regional Commission's Network Appalachia Study Group. Donovan is a member of the Transportation Research Board's Committee on Waterways and is founding member of SmartRivers. He currently serves in an advisory role to the Tri-State Airport Authority and the Cabell-Wayne Local Port Authority District. Donovan earned a master's degree in geography from Marshall University Graduate College, and also holds a bachelor's degree in geography from Marshall University.

### **PAULA DOWELL**

*Cambridge Systematics*

Paula Dowell is a Principal with Cambridge Systematics and has more than 16 years of experience in transportation economics and freight transportation planning. Since joining CS, she has served as project manager/senior consultant on the NCFRP 05 project examining the economic benefits of freight investments, the FHWA National Gateways and Corridors Concept, and large regional freight studies in Houston-Galveston and Central Florida areas. Throughout her career, Paula has managed more than a dozen multimodal freight, trade, and economic development studies throughout the United States and North America. Dowell holds a bachelor's degree in economics from East Tennessee State University and a masters and a PhD in economics from the University of Tennessee.



# 2013 JOINT ANNUAL FREIGHT MEETING



## SPEAKER BIOGRAPHIES, CONTINUED

### **BERNADETTE DUPONT**

*Federal Highway Administration, Kentucky Division*

Bernadette Dupont serves as a Transportation Specialist on the Program Delivery Team at the Federal Highway Administration's Kentucky Division Office, where she serves as the: Freight Specialist, Commercial Vehicle Size and Weight Coordinator, Air Quality Specialist, Transportation Planner, Environmental Specialist, CMAQ Program Manager, and Highway Performance Monitoring System Specialist. Prior to joining FHWA, Dupont was a research engineer for the Kentucky Transportation Center and a professor of mathematics at the local community college. Dupont holds bachelor's and master's degrees in civil engineering and a bachelor's degree in telecommunications from the University of Kentucky.

### **JAMIE FIEPKE**

*Kentucky Motor Transport Association*

Jamie Fiepke is the President and CEO of the Kentucky Motor Transport Association. He comes to KMTA with over 11 years' experience in the trucking industry. He spent the majority of this time in operations with a small company based out of Elizabethtown, KY. His responsibilities ranged from dispatching, safety management, human resources, truck registration, fuel taxes, and insurance renewals. He spent 2 years working for the Department of Transportation in the Division of Motor Carriers as their Director. The Division administers all the laws that apply to the commercial motor carrier, i.e. IFTA, KYU, KIT, IRP and overweight/over dimensional permits. For the past 6 years he has been the President of the Kentucky Motor Transport Association (KMTA). He currently serves on several transportation-related committees including the Louisville and Southern Indiana Bridge Authority, Commercial Information Sharing Network, and Governor's Executive Committee on Highway Safety. Fiepke holds a bachelor's degree in business administration from the University of Louisville.

### **MARSHA FIOI**

*Virginia Department of Transportation*

Marsha Fiol serves as State Transportation Planner for the Virginia Department of Transportation (VDOT). In this role, she oversees the functions related to the department's land development efforts, as well as the agency's transportation planning efforts in the central and district offices. She has over two decades experience working with VDOT in traffic engineering, permitting, project funding, and transportation planning positions both the field offices as well as the central office. Fiol has participated in efforts to develop the Governor's Multimodal Strategic Plan (2010) for the Commonwealth of Virginia, VDOT's Business (Strategic) Plan, the Commonwealth Transportation Board's Strategic Plan and the VTrans Action Plan, an annual multimodal strategic plan for the Commonwealth. Fiol currently serves on the FHWA/FTA Guidebook on Performance Based Planning and Programming Committee, and on the National MAP-21 Freight Implementation Team. She holds a bachelor's degree in business administration with a minor in finance from Austin Peay State University and a masters degree in transportation policy, operations, and logistics from George Mason University, School of Public Policy.

### **STEVE FITZROY**

*Economic Development Research Group, Inc.*

Stephen S. Fitzroy is a Senior Vice President and Director of Operations Research and Trade Analysis at Economic Development Research Group, Inc. His expertise is in analyzing the economic effects of investments in transportation infrastructure, especially with regard to the effects of these investments on regional competitiveness and the effects of transportation system productivity enhancements on key strategic economic sectors of the United States and regional economies. His current work includes assessing the economic impacts of both passenger and freight transportation system investments, including analysis and policy assessment projects ranging from development of economic impact assessment tools for the National Academy's Strategic Highway Research Program, to the economic effects of Panama Canal expansion on US port and inland freight transportation systems, to TIGER/PRIIA grant applications. Fitzroy holds a BS in civil



# 2013 JOINT ANNUAL FREIGHT MEETING



INSTITUTE FOR TRADE AND  
TRANSPORTATION STUDIES

## SPEAKER BIOGRAPHIES, CONTINUED

engineering from Drexel University, a master's in regional planning from Pennsylvania State University, and a PhD in urban and regional planning from Harvard University. He is a registered engineer (PE) in the State of Michigan.

### DAVID FRANKLIN

*Federal Highway Administration*

David Franklin is the US-Canadian Cross Border Coordinator with the Office of Planning, Federal Highway Administration. In this position, he serves as the liaison between many of the federal and state/provincial agencies that have a vested interest in the safe and efficient movement of people, goods, and vehicles across the US-Canadian border. He is the American Coordinator for the Transportation Border Working Group, a bi-national collaboration of US and Canadian government agencies that meet twice a year to discuss transportation, trade, and border security issues. From 2003 to 2008 he was a Transportation Planner and Environmental Specialist with the Indiana Division of the Federal Highway Administration. From 2001 to 2003 he was a Professional Development Program Participant working with the Iowa and Utah Divisions of the Federal Highway Administration as well as developmental assignments with the Salt Lake City, Utah and Dubuque, Iowa metropolitan planning organizations. Prior to working for the Federal Highway Administration, Franklin was the City Administrator of Anamosa, Iowa and a US Army Officer in the Military Police Corps. Franklin holds a bachelor's degree in criminal justice from the University of Nebraska-Omaha and a MPA from the University of Nebraska-Lincoln.

### J. THOMAS GARRETT

*Paducah & Louisville Railway, Inc.*

Tom Garrett is the President of P&L Transportation, Inc. and each of its subsidiary railroads: Paducah & Louisville Railway, Inc., Evansville Western Railway, Inc., and Appalachian and Ohio Railroad, Inc. Garrett has worked in the railroad industry for 26 years. He began his railroad career with Paducah & Louisville Railway, Inc., shortly after its formation, as General Counsel. In 1988 he was named Vice President and General Counsel of P&L, its then holding company, Rail Holdings, Inc. and affiliate, VMV Enterprises, Inc. From 1995-2010, Mr. Garrett served as Executive Vice President and General Counsel to P&L Transportation and its subsidiaries. Garrett also currently serves as President of the Kentucky Railroad Association and Immediate Past Chair of the Paducah Area Chamber of Commerce. He is also a member of various other industry and professional associations. Garrett holds a BA in business administration from the University of Kentucky and JD from the University of Kentucky College of Law.

### RAY GRIFFITH

*Kentucky Cabinet for Economic Development*

Ray Griffith is an Executive Staff Advisor within the Kentucky Cabinet for Economic Development, Office of Public Affairs and Research. He supports state economic initiatives to attract new business by conducting research and providing information and resources to clients considering locating to Kentucky, or expanding their existing Kentucky presence. In addition, he provides technical assistance on economic development-related projects and serves as an industry analyst researching and advising on the broad development of the US automotive and transportation industries. Griffith holds a bachelor's degree of business administration in finance from the University of Louisville and a MPA in policy analysis from the University of Kentucky.

### MIKE HANCOCK

*Kentucky Transportation Cabinet*

Mike Hancock is Secretary of the Kentucky Transportation Cabinet and a career Cabinet engineer. He was State Highway Engineer at the time that Governor Beshear designated him as Secretary. Hancock's experience with the Cabinet includes ten years in rural and urban transportation planning, ten years leading the Cabinet's program management function, eight years as Deputy State Highway Engineer for program planning and management, one year as the Cabinet's Chief of Staff,



# 2013 JOINT ANNUAL FREIGHT MEETING



## SPEAKER BIOGRAPHIES, CONTINUED

and one year as State Highway Engineer. He recently served as president of the Southeastern Association of State Highway and Transportation Officials (SASHTO) and as a member of the Executive Committee of the Board of Directors of the American Association of State Highway and Transportation Officials (AASHTO). He currently serves as Chairman of the AASHTO Standing Committee on Planning and as a member of the Executive Committee of the Transportation Research Board, a national panel that guides transportation research in the United States. Having been responsible for preparation of the Kentucky Highway Plan for many years, Hancock has worked closely with local, state, and national leaders in the area of project needs prioritization and transportation program funding issues. He is a graduate of the University of Kentucky.

### **DON HAYDEN**

*M&M Cartage Co, Inc.*

Don Hayden is the President of M & M Cartage Co., Inc, which operates a fleet of 170 trucks & 500 trailers and provides quality transportation services for 425 customers. The majority of loads handled are in the regional, dry van, truckload segment. Hayden serves on the Board of Directors for several organizations including the American Trucking Association, Kentucky Motor Transport Association and is also past chair of Kentucky Motor Transport Association. Hayden holds a bachelor's degree from the University of Louisville.

### **SUNDERESH HERAGU**

*University of Louisville*

Sunderesh S. Heragu is Professor and the Mary Lee and George F. Duthie Chair in Engineering Logistics in the Industrial Engineering department at the University of Louisville. He is also Director of the Logistics and Distribution Institute (LoDI). Previously he was Professor of Decision Sciences and Engineering Systems at Rensselaer Polytechnic Institute. He has taught at State University of New York, Plattsburgh and held visiting appointments at State University of New York, Buffalo, Technical University of Eindhoven and University of Twente, in the Netherlands and IBM's Thomas J. Watson Research Center in Yorktown Heights, NY. He completed his B.Eng in mechanical engineering at Malnad College of Engineering, Hassan, India (affiliated to University of Mysore), MBA at University of Saskatchewan, and PhD in industrial engineering at University of Manitoba.

### **ELLEN HESEN**

*Louisville Metro Government*

Ellen Hesén is the Chief of Staff in the Office of the Mayor for the Louisville Metro Government. As Chief of Staff for Mayor Greg Fischer, she is responsible for the day to day work of managing all the merged government's departments and their interactions with the mayor's office. Before joining the Mayor's office, she served as General Counsel in the Office of the Governor of the Commonwealth of Kentucky. She has also served in many capacities in the Kentucky Office of the Auditor of Public Accounts, the Cabinet for Health Services, and the Department of Medicaid Services. She has also practiced law in the private sector and for Jefferson County, Kentucky. Hesén holds a BA from Xavier University and a JD from the University of Louisville School of Law.

### **GREG HIGDON**

*Kentucky Association of Manufacturers*

Greg Higdon is President and CEO of the Kentucky Association of Manufacturers (KAM). He started his career in business working in and running several of his family's retail businesses in Western Kentucky. Higdon was elected to the Kentucky State Senate in 1981 where he served ten years and held several top posts including: Majority Whip, Chairman of the Agriculture and Natural Resources Committee, and Chair of the Capital Projects and Bond Oversight Committee. In 1991, he left the State Senate to serve as deputy secretary of the Natural Resources and Environmental Protection Cabinet and a governor's office special assistant. Higdon has been involved with the Kentucky Association of Manufacturers in several different capacities since 1994, including Director of the Chemical Industry Council and Policy Advisor to past presidents



# 2013 JOINT ANNUAL FREIGHT MEETING



INSTITUTE FOR TRADE AND  
TRANSPORTATION STUDIES

## SPEAKER BIOGRAPHIES, CONTINUED

of KAM. Higdon graduated from Brescia College in 1969 with a degree in business Administration, prior to serving in the US Army in Vietnam.

### **SHERREE HOCKENSMITH**

*Brown-Forman Corporation*

Sherree Hockensmith is the Manager of International Transportation for Brown-Forman Corporation. She is a proven global logistics supply chain manager for imports, exports, and customs compliance. Hockensmith confirmed her leadership skills when she lead a project team to obtain Customs and Trade Partners against Terrorism (C-TPAT) certification and validation for the Brown-Forman Louisville, Kentucky production facility in August, 2008, foreign validation at Canadian Mist in Collingwood, Ontario, Canada in June, 2008 for imported goods, and foreign re-validation at Finlandia Vodka Worldwide in August, 2011. Hockensmith holds a BS in business and commerce and a MBA in business administration and from Bellarmine College, and an AAS in office administration from the University of Louisville. She also completed Essentials of Logistics and Supply Chain Management Course at Loyola University.

### **SHELDON JOHNSON**

*Northwest Regional Planning Commission*

Sheldon Johnson is the Deputy Director of the Northwest Regional Planning Commission (NWRPC), Spooner Wisconsin and the Duluth, MN-Superior, WI Metropolitan Interstate Council (MIC), the bi-state MPO. He has been with NWRPC and the MIC since 1994. Prior to moving to northern Wisconsin, he was the Senior Planner/MPO Coordinator for the South Eastern Council of Governments in Sioux Falls, South Dakota. He is the Wisconsin representative on NADO's transportation leadership group, the National RPO Council of Peers, and is on the Board of Directors of the Transportation Development Association of Wisconsin.

### **LARRY KARNES**

*Michigan Department of Transportation*

Larry Karnes is a Transportation Planning Manager for the Michigan Department of Transportation (MDOT) and serves as Freight Policy Specialist. His work in freight transportation planning extends over thirty years and includes marine, rail, and truck transportation. He has managed several major freight studies for the State of Michigan, including a statewide port study, the Detroit Intermodal Freight Terminal study, and the recently completed State Rail Plan. Prior to joining MDOT, he served as chief planner for a regional planning agency and as an analyst for the federal government. Karnes holds degrees from Michigan State University, Western Michigan University, and Lake Michigan College. He completed additional coursework in transportation and management studies at the University of Tennessee, Lansing Community College, and The Ohio State University.

### **JANET KELLY**

*University of Louisville*

Janet M. Kelly is Professor of Urban and Public Affairs and Director of the Kentucky State Data Center at the University of Louisville. In 1981, an agreement between the Governor's Office and the US Census Bureau designated the Kentucky State Data Center as the official Census data repository for Kentucky. She is the Business and Industry Data Center (BIDC) leader for Kentucky. Other data center staff produce the official population forecasts for each Kentucky city and county. Kelly's research interests include state-local finance and regional economics.



# 2013 JOINT ANNUAL FREIGHT MEETING



## SPEAKER BIOGRAPHIES, CONTINUED

### **BRUCE LAMBERT**

*Institute for Trade and Transportation Studies*

Bruce Lambert is the Executive Director of the Institute for Trade and Transportation Studies (ITTS), a multistate research institution formed to assist member states on understanding the relationship of transportation needs to international and commercial traffic. With over twenty years of experience, Lambert has worked for various entities engaged in transportation activities before joining ITTS. At the Corps of Engineers, he worked on general maritime policy and planning, while also serving as the Secretary to the US Section of the International Navigation Association (PIANC), and worked on technology exchanges with the Latin American maritime community. Prior to joining the USACE, Lambert worked at the Federal Highway Administration where he managed the Freight Analysis Framework study and developed performance measures for trucking movements on the interstate system. Before joining FHWA, he worked as a Senior Economist at Standard and Poor's DRI (now IHS Global Insight), where he examined global maritime shipments and international trade forecasts. Lambert spent six years at the Port of Long Beach as the Port's Trade Analyst, conducting market research for senior management. He also spent a year at LSU as a researcher studying the importation of Latin American produce into the Gulf South. Lambert holds a BS from Louisiana State University and a MS from the University of Tennessee.

### **LLOYD MACADAM**

*Ohio Department of Transportation*

Lloyd MacAdam is the Deputy Director of District 11 of the Ohio Department of Transportation (ODOT). He has also served the department as a Regional Projects Manager for ODOT's Northeast Ohio's Real Estate Office in Akron. Prior to his career in ODOT, MacAdam worked for the City of Akron Bureau of Engineering, the Summit County Engineer's office, four different engineering design firms and was a full time professor at the Kent State University Tuscarawas Campus in the Engineering Technology Department. MacAdam holds a BS in civil engineering. In addition to being a professional engineer, MacAdam also has his professional surveyor's license and was a 2008 graduate of Ohio's Certified Public Manager Program.

### **BRANDON MASON**

*PwC*

Brandon Mason serves as the Americas leader of PwC's Autofacts group in Detroit, Michigan. He also leads the Autofacts global powertrain forecast, with a specialization in advanced powertrain technology and oversees industry trends such as alternative fuel strategies, emissions reduction, and the introduction of new technologies into the automotive sector. Brandon joined PwC in 2004. Since his time at the firm, he has authored numerous thought leadership pieces related to vehicle electrification and other alternative fuel solutions. He has been quoted in numerous publications and media outlets, including Michigan Radio, Automobile Magazine, Greentech Media, Automotive News, Consumers Digest and the Huffington Post. Mason is a graduate of Michigan State University.

### **TOM MCQUEEN**

*Georgia Department of Transportation*

Tom McQueen serves as an Assistant Planning Administrator in the Georgia Department of Transportation's Office of Planning. Since starting with GDOT in 1995, he has managed some of the state's largest and most complex planning studies—including the Georgia Freight and Logistics Plan, which received FHWA's 2012 "Excellence in Planning Award." His project portfolio also includes other freight-focused studies such as the Georgia Truck-Only Needs Identification Study and Georgia's Interstate System Plan. Prior to joining GDOT, he worked as a Transportation Planner at the Miami Valley Regional Planning Commission in Dayton, Ohio. McQueen holds a master's degree in regional planning from the University of Cincinnati and has been a member of the American Institute of Certified Planners since 1993.

# 2013 JOINT ANNUAL FREIGHT MEETING



INSTITUTE FOR TRADE AND  
TRANSPORTATION STUDIES

## SPEAKER BIOGRAPHIES, CONTINUED

### **ROY NORTON**

*Canadian Consulate*

Roy Norton is the Consul General of Canada based in Detroit, where he represents Canada in Michigan, Ohio, Indiana and Kentucky. Prior to this posting, Norton served the Canadian Embassy in Washington, DC, as Minister (Congressional, Public and Intergovernmental Relations). From 2000 until 2006 Norton was based in Toronto, working for the Government of Ontario as Assistant Deputy Minister, International Relations, and Chief of Protocol in the Ministry of Intergovernmental Affairs, as Assistant Deputy Minister for Export Development, and President/CEO of Ontario Exports Inc., in the Ministry of Economic Development and Trade. He also served in the Canadian Embassy's Economic Section in Washington, DC and was a member of Canada's negotiating teams for the intellectual property and investment chapters of NAFTA. He has also worked in the Canadian Parliament (first in the House of Commons, then in the Senate) and, subsequently, for five years, as Senior Policy Advisor to the Canadian Foreign Minister. Norton holds a MA in Canadian History from Carleton University, a MPA from Harvard's Kennedy School of Government, a master's in international public policy from the Johns Hopkins University School of Advanced International Studies (SAIS), and a PhD in international relations from the Johns Hopkins University (SAIS).

### **LIBBY OGDARD**

*Prime Focus, LLC*

Libby Ogard is President of Prime Focus, LLC. She spent 17 years in the railroad industry working for Burlington Northern and Conrail in the intermodal and carload marketing area. In 1993 she joined Schneider National and spent 7 years in the TruckRail and National Account area. As General Manager of Retail Sales Division of Schneider National, Ogard managed private fleet operations, brokerage and intermodal services for Target, Walgreens, Family Dollar and Home Depot. She is a supply chain expert with many contacts in the private sector. She is actively involved in Transportation Research Forum and Transportation Research Board. She has co-authored a number of papers and research projects concerning intermodal terminal assessments, modal conversion, highway pavement damage as a result of mode conversion and foreign trade zone studies.

### **LEO PENNE**

*American Association of State Highway and Transportation Officials*

R. Leo Penne is Program Director for Freight Transportation and Economic Development with the American Association of State Highway and Transportation Officials (AASHTO). He manages AASHTO's committees on rail, maritime, trucking, and intermodal transportation. Previously, Penne held the following positions: Director, State of Nevada, Washington, DC Office; Program Director for Housing, Community and Economic Development, Public Technology Inc.; Director, Office of Policy Analysis and Development, Economic Development Administration, US Department of Commerce; Senior Legislative Counsel and Assistant Director of the Office of Policy Analysis, National League of Cities; and, President, R. Leo Penne Associates, Inc. Penne holds degrees in political science from Seattle University and the University of Washington.

### **ERNIE PERRY**

*University of Wisconsin-Madison*

Ernie Perry is the Program Administrator and Facilitator of the Mid-America Freight Coalition. Before joining the National Center for Freight and Infrastructure Research and Education, Perry was the Administrator of Freight Development at the Missouri Department of Transportation. During his seventeen-year tenure at MoDOT, he also served as research administrator, organizational results administrator, senior environmental specialist, and socioeconomic specialist. Perry has worked closely with freight leadership at AASHTO, FHWA, and MARAD, served on NCFRP panels, and participated in the Scan of European Union Freight Corridors. Perry holds a BS in animal science, an MS in rural sociology, and a PhD in rural sociology from the University of Missouri-Columbia.



# 2013 JOINT ANNUAL FREIGHT MEETING



## SPEAKER BIOGRAPHIES, CONTINUED

### **FRANC PIGNA**

*Aegir Port Property Advisors*

Franc J. Pigna is the Managing Director of Aegir Port Property Advisors. Aegir is a pioneer in property and real estate consultancy, specializing in meeting the unique property challenges faced by ports and related maritime and logistics industries. Aegir's focus is in developing competitive advantages, enhancing property based revenue streams and maximizing ports' value through the more strategic use of a port's largest asset—its property—with practical, market driven solutions. He is a member of the Counselors of Real Estate in the United States and is a Fellow and Chartered Management Consultant of the Royal Institution of Chartered Surveyors in the United Kingdom. He is a frequent speaker at industry events and universities and has authored several papers and articles on port property and corporate real estate matters.

### **MICHAEL REED**

*University of Kentucky*

Michael Reed is Professor of Agricultural Economics and Director of International Programs for Agriculture at the University of Kentucky. He also directs the graduate program in agricultural economics. Reed's principal area of research and teaching is international trade in agricultural products. His research includes the effects of macroeconomic policies and exchange rates on US food exports, the dynamics of consumer demand in various countries, and the effects of competition patterns on world agricultural trade patterns. Reed holds a PhD in economics (with a minor in statistics) from Iowa State University. He also holds a Doctor Honoris Causa (Honorary PhD) from Bucharest University of Agricultural Sciences and Veterinary Medicine.

### **ED RINEY**

*Owensboro Riverport Authority*

Ed Riney is the President and CEO of the Owensboro Riverport Authority. Prior to joining the Riverport, he was President of Lingate Hospitality, a company that operated twenty-three Hilton and Marriott branded hotels. Previously he was General Manager and later Publisher of the Owensboro Messenger Inquirer for 14 years. Riney started his career at Green River Steel in Owensboro where he worked for 11 years before moving to corporate headquarters in New Jersey as Group Controller. Riney serves on Boards of Directors of the Greater Owensboro Economic Development Corporation, Greater Owensboro Chamber of Commerce, Inland Rivers, Ports and Terminals Board, Kentucky Transportation Waterways Advisory Board, and was recently Vice Chair of the Kentucky Association of Riverports. Riney holds a bachelor's degree in accounting from Brescia University.

### **BEN RITCHEY**

*Acadia Group, LLC*

Benjamin Ritchey is President of the Acadia Group, LLC. He has 30 years of transportation research and related experience, primarily for US Department of Transportation (US DOT) and transportation industry, and for the US Departments of Homeland Security (US DHS) and Energy (US DOE). His experience includes: strategy development (with business development and technology responsibilities), future technology and condition research, and project management (with US DOT/US DHS IDIQ contracts and major projects). He has recently finished (as a subcontractor to RD Mingo and Associates) a futures report on the Interstate System Rights of Way for the FHWA Office of Policy. Currently, he is Co-Chair of the Columbus Region Logistics Council and interacts with major supply chain industry players. Also, he participates on several boards (non-profits, professional, arts, and academic). Ritchey holds a BA in political science from Pennsylvania State University and a MPA from George Washington University.

# 2013 JOINT ANNUAL FREIGHT MEETING



INSTITUTE FOR TRADE AND  
TRANSPORTATION STUDIES

## SPEAKER BIOGRAPHIES, CONTINUED

### **JOSÉ M. SEPÚLVEDA**

*Federal Highway Administration*

José M. Sepúlveda is the Kentucky Division Administrator for the Federal Highway Administration. He leads a multi-disciplinary team which administers the Federal-aid highway program in Kentucky. He joined the FHWA in 1980 as a highway engineer in the former Region 15 Direct Federal Programs Office. Since, Sepúlveda has held multiple positions in FHWA, including: safety engineer in the Headquarters Office of Safety and Traffic Operations, Special Assistant to the Region 5 Regional Administrator, Region 5 Emergency Transportation Representative, Technology Advancement Team Leader in the Wisconsin Division, Assistant Division Administrator in Puerto Rico, and Territorial Representative to the U.S. Virgin Islands. In 1997, Sepúlveda was appointed Division Administrator of the Puerto Rico Division. He has received numerous performance awards and has received the FHWA Administrator Superior Achievement Award in three occasions. Sepúlveda holds a BS in civil engineering from the University of Puerto Rico.

### **SCOTT SIGMAN**

*Illinois Soybean Association*

Scott Sigman has more than 25 years of experience in global trade and transportation planning, assessment of economic impacts, preparation of reports, business plans, assessments, and studies focused on container intermodal as well as multimodal freight operations. Sigman holds a BA in economics and international relations from the University of Wisconsin-Madison and a MS in economics (sea use law, economics, and policy) from the University of London, London School of Economics and Political Science.

### **CHARLES SMITH**

*Hanson Professional Services*

Charles Smith, PE is a Project Manager and Senior Engineer in the Ports and Harbors group of Hanson Professional Services, Inc. His broad experience includes all phases of planning, public involvement, design, permitting, and construction of roadways, highways and bridges; railroad improvements; environmental studies; and general civil site development for ports, airfields, industrial parks and educational facilities. His engagements over the last six years have focused on market studies, master planning, economic impacts, and engineering for private and public ports and river corridors as part of multimodal transportation systems. Prior to joining Hanson in 1999, Smith worked for the Illinois Department of Transportation and served in the US Air Force. He holds a BS and MS in civil engineering from Southern Illinois University and an MBA from Northern Illinois University.

### **LYNN SOPOROWSKI**

*Kentucky Transportation Cabinet*

Lynn Soporowski, PE is a Transportation Engineering Branch Manager for the Kentucky Transportation Cabinet, in Frankfort, KY with 23 years of service. She works for the Division of Planning, which is responsible for traffic forecasting and modeling, regional air quality conformity, congestion management, and the coordination of the multimodal aspects of transportation including bicycle, pedestrian, ferry, riverport, rail, and freight traffic. She serves on NCHRP/ NCFRP committees, the TRB Air Quality Committee, and the Technical Committee on Non-motorized Transportation. Soporowski holds a BS in civil engineering from Tennessee Technological University and a master's degree in civil engineering from the University of Kentucky.

### **JOHN TOMPKINS**

*Minnesota Department of Transportation*

John Tompkins is a freight project manager for the Minnesota Department of Transportation. John has more than 26 years in the transportation field. He began his career as a Freight Traffic Specialist for the United States Air Force where he





# 2013 JOINT ANNUAL FREIGHT MEETING



## SPEAKER BIOGRAPHIES, CONTINUED

received a meritorious service commendation for freight logistics operations. Tompkins has been with MnDOT for the past 18 years managing freight planning and research projects. He serves as state freight representative in multistate coalitions, staff coordinator for the Minnesota Freight Advisory Committee, and as a member of national Transportation Research Board (TRB) Urban Goods Movement Committee.

### **CAITLYN HUGHES RAYMAN** *Federal Highway Administration*

Caitlin Hughes Rayman is Director of the Office of Freight Management and Operations of the Federal Highway Administration. Previously, she served as assistant secretary for transportation policy and freight at the Maryland Department of Transportation, where she has been responsible for overseeing the development and advancement of legislation, policies, and solutions to improve multimodal freight issues. Before her time at Maryland DOT, Rayman served as Federal Programs Coordinator at North Carolina Department of Transportation where she helped to advance freight mobility initiatives. Rayman is a member of the American Association of State Highway and Transportation Officials' Standing Committee on Rail Transportation.

### **JACK WELLS** *U.S. Department of Transportation*

Jack Wells has been the Chief Economist at the US Department of Transportation since 2004. His major focus has been on using economic analysis to make the transportation system more efficient through greater use of benefit-cost analysis and asset management techniques, use of economic, and expanding deployment of innovative transportation technology. He is currently responsible for implementing the freight provisions in MAP-21, the surface transportation reauthorization act enacted in 2012. Wells served previously as Chief Economist at the Bureau of Transportation Statistics (2001-2004), Deputy Administrator of the Federal Railroad Administration (2000-2001), Minority Staff Director of the House Subcommittee on Railroads (1995-2000), Staff Director of the Subcommittee on Investigations and Oversight of the House Public Works and Transportation Committee (1993-1995), Economist at the US General Accounting Office, working on transportation, regulation, and science and technology policy issues (1979-1992), and Assistant Professor of Economics at George Mason University (1975-1979). Mr. Wells has a BA from Harvard and a PhD from Yale, both in economics.

### **NORB WHITLOCK** *River Trends, LLC*

William "Norb" Whitlock is President of River Trends, LLC. He has been a leader in the river industry for 40+ years. His service on the Inland Waterways Users Board has led to improvements of the entire inland system, particularly the Ohio, Mississippi, and Gulf Intracoastal waterways. He has contributed to both infrastructure improvements and safety improvements through industry and government partnerships. A major achievement was the design of the "temporary" lock expansion to Lock and Dam 52, which is still in operation 37 years later, passing 90 million tons of freight annually. During his tenure, he has received numerous awards for service to the industry, including the Department of the Army's Outstanding Citizen Service Medal in 2001, the Coast Guard's Meritorious Public Service Medal in 2003, and the Achievement Award from National Mississippi River Museum & Aquarium in 2007. Whitlock began his career with the US Army Corps of Engineers as chief of operations for the Louisville District. Whitlock holds a bachelor's degree in civil engineering from the University of Louisville.

### **CHERYL WILLIAMS** *DHL Express*

Cheryl Williams is Manager of International Sales with DHL Express. With over 30 award-winning years of transportation experience, she is proud to represent the global market leader in the logistics industry. She has successfully helped companies of all sizes with creative solutions to expand their global presence. Working with her colleagues in over 220



# 2013 JOINT ANNUAL FREIGHT MEETING



## SPEAKER BIOGRAPHIES, CONTINUED



INSTITUTE FOR TRADE AND  
TRANSPORTATION STUDIES

countries she brings a unique synergy of solutions and innovations to her clients from the initial concept to market readiness.

### **ROZ WILSON**

*Delcan*

Roz Wilson is a Senior Business Analyst with Delcan's Infrastructure National Business based in Tysons, Virginia. She is an internationally recognized supply chain expert with more than 30 years of experience in the transportation and logistics field. She analyzes the performance of logistics and supply chain industry sectors, identifies and analyzes key issues facing the transportation industry and provides insight to government and corporate entities and the press. She is also a widely-recognized expert in transportation economics and supply chain security. She has extensive railroad industry experience, and has served in various capacities for over 11 years at the Association of American Railroads. She has more than ten years experience in supply chain security and resiliency and six years experience in information security for defense and national security clients. She is the author of the 23-year old Annual State of Logistics Report®, a widely used analysis of the supply chain industry published by the Council of Supply Chain Management Professionals and Penske Logistics. In 2006 Wilson co-authored *Securing Global Transportation Networks*, a supply chain security reference and college textbook, which is currently under revision.

### **DARRELL WILSON**

*Norfolk Southern Corporation*

Darrell Wilson is Assistant Vice President of Government Relations with Norfolk Southern. Prior to joining Norfolk Southern, he served three different members of Congress on Capitol Hill, including the former Chairman of the Transportation Committee in the House, Bud Shuster from Pennsylvania. While working for the House of Representatives for 12 years, he spent more than 7 years on the Transportation and Infrastructure Committee as a senior professional staffer. During his tenure on the Committee he served on the Rail and Surface Subcommittees and at the Full Committee level as the Special Assistant to the Chairman. During his last two years on Capitol Hill, he served as Chief of Staff to Congressman Bud Shuster. During this time the committee crafted numerous landmark pieces of legislation, including the ICC Termination Act of 1995, which created the Surface Transportation Board, the NHS Designation Act of 1995, Amtrak Reform Act, the Federal Aviation Administration Reauthorization, ARC, EDA and the Transportation Equity Act for the 21st Century. His present responsibilities at Norfolk Southern include monitoring legislative and regulatory developments on Capitol Hill and at the STB, FHWA and FRA. He also follows the development of public-private partnerships between states, the FHWA, and private industry.







































UPS delivers all across the globe.  
But this is where the action is.

## UPS Customer Relations - Louisville, KY

### Visitor Guidelines:

- UPS employees are required to display a company issued ID during visits to the Air Park. All other visitors will be required to present a government issued photo ID (driver's license or passport) before admittance onto airport property. If you are not from the US, a Passport is required. There will be NO EXCEPTIONS to this policy.
- Please wear comfortable closed-toe footwear. You will be doing a great deal of walking throughout the facilities, including stairs. Business casual attire is acceptable, high heel shoes and dresses/skirts are not recommended. For safety reasons, open-toed shoes are not permitted at Worldport.
- For safety reasons, the consumption of alcohol before and during the visit is strictly prohibited.
- No cameras or video recorders are allowed in the Worldport facility.
- All visitors to the ramp must pass through magnetic scanners. Anything that would not pass through current United States airport security gates (such as bladed instruments of any kind) will not be allowed on the UPS ramp. Please leave these items at your hotel.
- **NO EARLY ARRIVALS, PLEASE!** We will be hosting other customers during your visit, so it is important to follow the agenda start time.

### Directions from Downtown:

Take I-65 South toward Nashville. Take exit 128, and Merge on Fern Valley Rd.  
Turn Right on to Fern Grade. Turn Left onto Grade Ln.  
Turn in the 2nd Parking lot entrance on the right into the UPS Flight Training Center building #31.  
Reserved parking is located in front of the glass double door entrance.

Travel time is approximately 10 minutes.













# 2013 JOINT ANNUAL FREIGHT MEETING



INSTITUTE FOR TRADE AND  
TRANSPORTATION STUDIES

## CONFERENCE ATTENDEES

### **Teresa Adams**

Center for Freight & Infrastructure  
Research & Education  
adams@engr.wisc.edu

### **Dike Ahanotu**

Cambridge Systematics  
Dahanotu@camsys.com

### **Charlie A. Allen**

KYTC District Four  
CharlieA.Allen@ky.gov

### **Sharon Balfour**

Louisiana DOTD  
sharon.balfour@la.gov

### **Cheryl Ball**

Missouri DOT  
Cheryl.Ball@modot.mo.gov

### **Robyn Bancroft**

OKI Regional Council of Governments  
rbancroft@oki.org

### **Tom Beck**

Indianapolis Metropolitan Planning  
Organization  
thomas.beck@indy.gov

### **Lisa Beneker**

Mid-America Freight Coalition  
beneker@engr.wisc.edu

### **Mark Berndt**

Olsson Associates  
Mark Berndt <mberndt@  
olssonassociates.com>

### **Rich Biter**

Florida DOT  
richard.biter@dot.state.fl.us

### **Dane Blackburn**

KYTC District Five  
Dane.Blackburn@ky.gov

### **Bret Blair**

KYTC District Seven  
Bret.Blair@ky.gov

### **Jessica Blankenship**

Cumberland Valley Area Development  
District  
jessicab@cvadd.org

### **Brandon Booth**

Lincoln Trail Area Development District  
brandon@ltadd.org

### **Brett M. Bourgeois**

New Orleans Board of Trade  
Brett Bourgeois <brett@nobot.org>

### **Carol Brent**

Kentucky Transportation Cabinet  
carol.brent@ky.gov

### **Ken Brotheridge**

Wisconsin DOT  
Kenneth.Brotheridge.dot.wi.gov

### **Jim Bruce**

UPS

### **Trevor Brydon**

Southeast Michigan Council of  
Governments  
Brydon@semcog.org

### **Keith Bucklew**

CDM Smith  
BucklewKJ@CDMSmith.com

### **Frank Burkett**

FHWA - Ohio Division  
frank.burkett@dot.gov

### **Mark Burton**

The University of Tennessee - Center for  
Transportation Research  
mburton3@utk.edu

### **Carol Callan-Ramler**

KYTC District Six  
Carol.Callan-Ramler@ky.gov

### **Sherri Chappell**

KYTC District Eleven  
Sherri.Chappell@ky.gov

### **Keith Damron**

KYTC  
Keith.Damron@ky.gov

### **Edward Dawson, Jr.**

Kansas DOT Freight and Rail Office  
Dawson@ksdot.org

### **Dennis Decker**

Louisiana DOTD  
dennisdecker@la.gov

### **Brandon Dennison**

Wayne County Economic Development  
Authority  
brandon.dennison@wceda.org

### **Patrick Donovan**

Rahall Transportation Institute  
pdonovan@njrati.org

### **Paula Dowell**

Cambridge Systematics, Inc.  
pdowell@camsys.com

### **Christine Drennen**

Toledo Metropolitan Area Council of  
Governments  
drennen@tmacog.org

### **Bruce Duncan**

Bluegrass ADD  
dduncan@bgadd.org

### **Bernadette Dupont**

Federal Highway Administration -  
Kentucky Division Office  
Bernadette.Dupont@fhwa.dot.gov

### **Chuck Dyer**

Ohio DOT  
Chuck.Dyer@dot.state.oh.us

### **Britt Edwards**

Illinois DOT  
Britt.Edwards@illinois.gov

### **Bill Eisele**

Texas A&M Transportation Institute  
bill-eisele@tamu.edu



# 2013 JOINT ANNUAL FREIGHT MEETING



## CONFERENCE ATTENDEES

**Steven Elmer**

Metropolitan Council  
Steven.Elmer@metc.state.mn.us

**Jeff Ely**

Mississippi DOT  
jely@mdot.ms.gov

**Randall Embry**

KIPDA Area Development District  
randall.embry@ky.gov

**Darryl Fields**

Mid-America Regional Council  
dfields@marc.org

**Marsha Fiol**

Virginia DOT  
marsha.fiol@vdot.virginia.gov

**Stephen Fitzroy**

Economic Development Research  
Group, Inc.  
sfitzroy@edrgroup.com

**Christopher Fleming**

WV Public Port Authority  
christopher.t.fleming@wv.gov

**Juan Flores**

Florida DOT  
juan.flores@dot.state.fl.us

**Stratius G. Fotos**

WV Public Port Authority  
mia.d.crookshanks@wv.gov

**David Franklin**

USDOT FHWA/Office of Planning,  
Border and Interstate Team  
david.franklin@dot.gov

**Bob Fredman**

SF Global Insights, LLC  
bfredman@sfginsights.com

**J. Thomas Garrett**

Paducah & Louisville Railway, Inc.  
jtgarrrett@palrr.com

**Mark Giuffré**

UPS  
mgiuffre@ups.com

**Ray Griffith**

Kentucky Cabinet for Economic  
Development  
Ray.Griffith@ky.gov

**Jessie Gwilliams**

Michigan DOT  
GwilliamsJ@michigan.gov

**Nick Hall**

KYTC - District 2  
nick.hal@ky.gov

**Tom Hall**

KYTC District Five  
Tom.Hall@ky.gov

**James Ham**

Kentucky Transportation Cabinet  
James.Ham@ky.gov

**Mike Hancock**

Kentucky Transportation Cabinet

**Maria Hart**

Mid-America Freight Coalition  
mhart@wisc.edu

**Don Hayden**

M&M Cartage  
donhayden@mmcartage.com

**Bob Helton**

R J Corman Railroad Group  
bob.helton

**Deneatra Henderson**

KYTC District Three  
Deneatra.Henderson@ky.gov

**Sunderesh Heragu**

University of Louisville  
sshera01@louisville.edu

**Jessica Herring**

KYTC District One

Jessica.Herring@ky.gov

**Ellen Hesen**

City of Louisville

**Tonya Higdon**

KYTC  
Tonya.Higdon@ky.gov

**Greg Higdon**

Kentucky Association of Manufacturers  
G.Higdon@kam.us.com

**Sherree Hockensmith**

Brown-Forman Corporation  
Sherree\_Hockensmith@B-F.com

**Eunice Holland**

Kentucky River Area Development  
District  
eunice@kradd.org

**David Holt**

Conexus Indiana  
dholt@conexusindiana.com

**Sajid Hossain**

Memphis MPO  
sajid.hossain@memphistn.gov

**Laura Hutsell****Matt Johns**

Louisiana DOTD  
christopher.johns@la.gov

**Sheldon Johnson**

Northwest Regional Planning  
Commission/Duluth-Superior  
Metropolitan Interstate Council  
sjohnson@nwrpc.com

**Melissa Johnson**

Port of Greater Cincinnati Development  
Authority  
mjohnson@portauthority.org

**Phil Jones**

Louisiana DOTD  
phil.jones@la.gov

# 2013 JOINT ANNUAL FREIGHT MEETING



## CONFERENCE ATTENDEES



INSTITUTE FOR TRADE AND  
TRANSPORTATION STUDIES

### Jacqueline Kamin

WisDOT Research & Library Unit  
jacqueline.kamin@dot.wi.gov

### Larry Karnes

Michigan DOT  
KarnesL@michigan.gov

### Venetta Keefe

Indiana DOT Rail Office  
Vkeefe@Indot.IN.gov

### Janet M. Kelly

University of Louisville  
Janet.Kelly@louisville.edu

### Janet Kelly

University of Louisville  
Janet.kelly@louisville.edu

### Lori Kelsey

Louville, KY-IN MPO  
Lori.Kelsey@ky.gov

### Matthew Killion

Missouri DOT  
Matthew.Killion@modot.mo.gov

### Linda Koenig

Oklahoma DOT  
cmoody@odot.org

### Bruce Lambert

Institute for Trade and Transportation  
Studies (ITTS)  
bruce@ittsresearch.org

### Ed Lee

Florida DOT  
robert.lee@dot.state.fl.us

### Marty Lipinski

University of Memphis, IFTI  
mlipinsk@memphis.edu

### Mark Locker

Ohio DOT  
Mark.Locker@dot.state.oh.us

### Pete Lynch

Wisconsin DOT  
Peter.Lynch@dot.wi.gov

### Lloyd MacAdam

Ohio DOT  
Lloyd.MacAdam@dot.state.oh.us

### Alex Marach

Mid-America Freight Coalition  
amarach@wisc.edu

### Bradley Marion

Missouri DOT  
Bradley.Marion@modot.mo.gov

### Urvashi Martin

Wisconsin DOT  
urvashi.martin@dot.wi.gov

### Richard S. Martinko, P.E.

The University of Toledo  
Richard.Martinko@utoledo.edu

### Brandon Mason

PricewaterhouseCoopers LLP  
Brandon.w.mason@uw.pwc.com

### Judy Matthews

John S. Connor, Inc.  
judym@jsconnor.com

### Gena McCullough

Bi-State Regional Commission  
gmmcullough@bistateonline.org

### Andrew McDonald

Metropolitan Interstate Council  
amcdonald@arcd.org

### Larry McFall

Jefferson Riverport  
lmcfall@jeffrvrpt.win.net

### Chris McGrath

Providence Logistics

### Tom McQueen

Georgia DOT  
tmcqueen@dot.ga.gov

### Alan Meadors

Arkansas State Highway and  
Transportation Department  
alan.meadors@ahtd.ar.gov

### Daniel Menetrey

KYTC District Six  
Daniel.Menetrey@ky.gov

### Leah Mosall

Capital District Transportation  
Committee  
lmosall@cdtcmpo.org

### Eric Neff

Ohio DOT  
Eric.Neff@dot.state.oh.us

### Roy Norton

Canadian Consul General

### Jeff O'Dell

UPS  
jodell@uos.com

### Craig O'Riley

Craig.Oriley@DOT.iowa.gov

### Libby Ogard

Prime Focus LLC  
logard@new.rr.com

### AJ Peake

KYTC District Five  
Judi.Hickerson@ky.gov

### Leo Penne

AASHTO  
LPenne@ashto.org

### Leo Penne

AASHTO

### Ernie Perry

Mid-America Freight Coalition  
ebperry@wisc.edu

### Christina Peterson

U.S. Sen. Rand Paul  
Christina\_Peterson@paul.senate.gov



# 2013 JOINT ANNUAL FREIGHT MEETING



## CONFERENCE ATTENDEES

**Joe Petrolino**

NTRCI  
joseph.petrolino@ntrci.org

**Franc Pigna**

Aegir  
pigna@aegirports.com

**Greg Pritchett**

Henderson County Riverport  
greg.pritchett@hendersonport.com

**Walt Raith**

Easy Central Wisconsin Regional  
Planning Commission  
Wraith@eastcentralrpc.org

**Andrew Ray**

Memphis Urban Area MPO  
Andrew.Ray@memphistn.gov

**Caitlin Rayman**

Federal Highway Administration  
caitlin.rayman@dot.gov

**Michael Reed**

University of Kentucky  
mrreed@uky.edu

**Michael Riley**

Indiana DOT Rail Office  
MDRiley@indot.IN.gov

**Ed Riney**

Owensboro Riverport  
eriney@OwensboroRiverport.com

**John Ripy**

KYTC  
jripy@uky.edu

**Benjamin Ritchey**

Acadia Group, LLC  
britchey@acadiagroupllc.com

**David Schrank**

Texas A&M Transportation Institute  
d-schrank@tamu.edu

**Amy Scott**

Barren River Area Development District  
ascott@bradd.org

**Jose Sepulveda**

FHWA - Kentucky Division Office  
Jose.Sepulveda@dot.gov

**Scott Sigman**

Illinois Soybean Association  
sigmans@ilsoy.org

**Eric M. Singley**

U.S. Army Corps of Engineers  
eric.m.singley@usace.army.mil

**Ricky Sizemore**

KYTC District Seven  
Ricky.Sizemore@ky.gov

**Mike Skaggs**

Lincoln Trail Area Development District  
mskaggs@ltadd.org

**Joel Skelley**

Kansas DOT  
Joelsk@ksdot.org

**Ron Slone**

KYTC District Twelve  
Ronald.Slone@ky.gov

**Chris Smith**

AASHTO  
CSmith@aaashto.org

**DeAnna Smith**

Illinois DOT  
Deanna.Smith@illinois.gov

**Charlie Smith**

Hanson Professional Services, Inc.  
csmith@hanson-inc.com

**Lynn Soporowski**

KYTC  
Lynn.Soporowski@ky.gov

**Pragati Srivastava**

Memphis MPO  
pragati.srivastava@memphismn.gov

**Jeff Thelen**

Northern Kentucky Area Development  
District  
jeff.thelen@nkadd.org

**John Tompkins, Jr.**

Minnesota DOT  
John.Tompkins@state.mn.us

**Trung Trinh**

Mississippi DOT  
ttrinh@mdot.ms.gov

**Randy Turner**

KYTC District Seven  
Randy.Turner@ky.gov

**Kimberly Vachal**

Upper Great Plains Transportation  
Institute - North Dakota State  
University  
kimberly.vachal@ndsu.edu

**Juan Villa**

Cambridge Systematics  
j-villa@tamu.edu

**Casey Wells**

KYTC  
Casey.Wells@ky.gov

**Brent Wells**

KYTC District Nine  
Mark.Westfall@ky.gov

**Jack Wells**

U.S. DOT  
claudette.pandohie@dot.gov

**Mark A. Westfall**

KYTC District Twelve  
Brent.Wells@ky.gov

**Norb Whitlock**

Rivertrends, LLC  
norbwhitlock@yahoo.com

# 2013 JOINT ANNUAL FREIGHT MEETING



INSTITUTE FOR TRADE AND  
TRANSPORTATION STUDIES

## CONFERENCE ATTENDEES

### **Stan Williams**

*Clarksville MPO*

*stanwilliams@cityofclarksville.com*

### **Cheryl Williams**

*DHL*

*Cheryl.L.Williams@dhl.com*

### **Darrell L. Wilson**

*Norfolk Southern*

*Darrell.wilson@nscorp.com*

### **Roz Wilson**

*Delcan Corp.*

*r.wilson@delcan.com*

### **Thomas Witt**

*KYTC*

*Thomas.Witt@ky.gov*

### **Erika Witzke**

*Cambridge Systematics*

*ewitzke@camsys.com*

### **Ben Zietlow**

*Mid-America Freight Coalition*

*bzietlow@wisc.edu*





# 2013 JOINT ANNUAL FREIGHT MEETING



INSTITUTE FOR TRADE AND  
TRANSPORTATION STUDIES

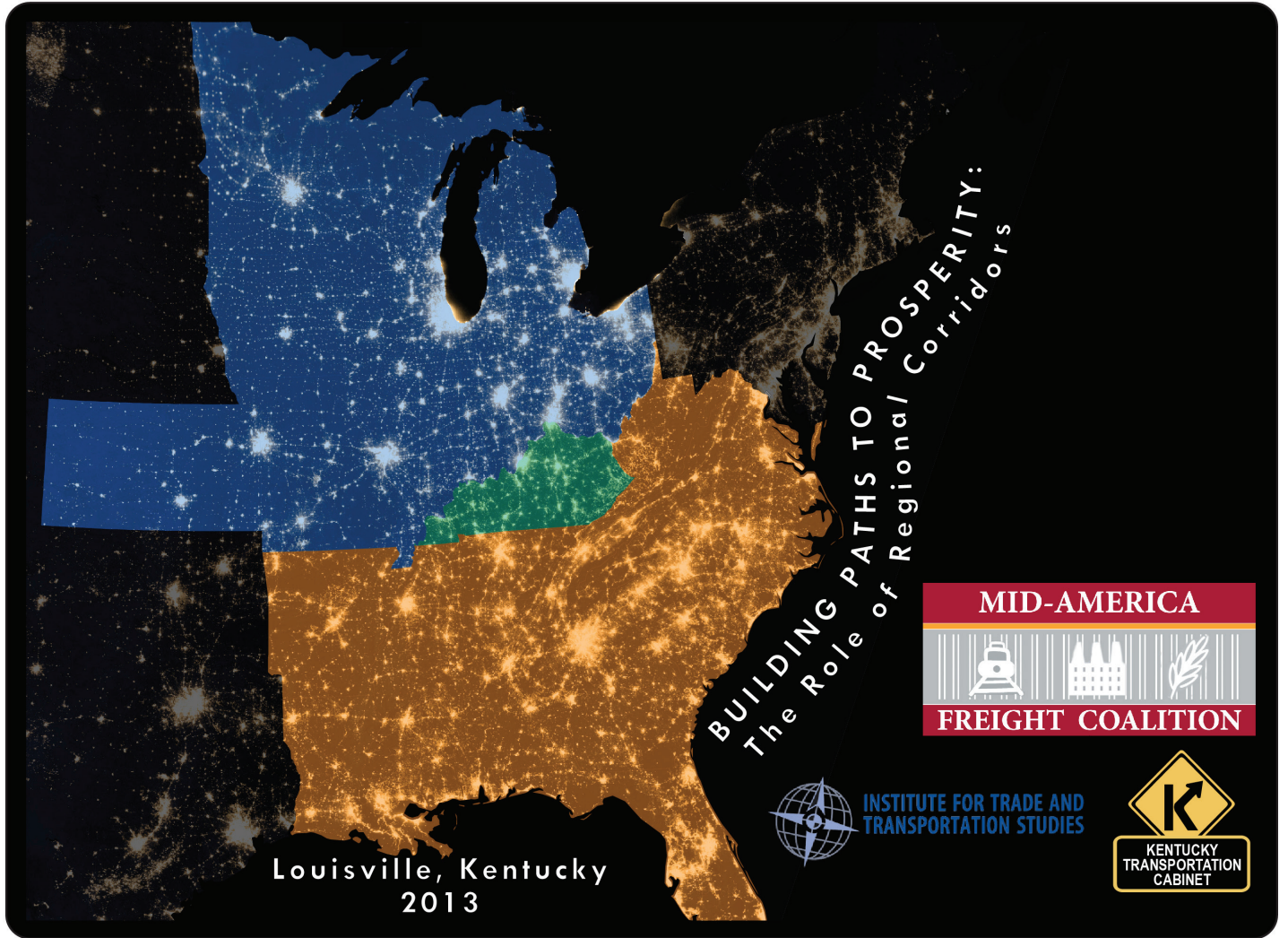

Louisville, Kentucky  
2013

BUILDING PATHS TO PROSPERITY:  
The Role of Regional Corridors



INSTITUTE FOR TRADE AND  
TRANSPORTATION STUDIES







**THE 2013 JOINT ANNUAL FREIGHT MEETING**

**IS SPONSORED BY**

**MID-AMERICA**

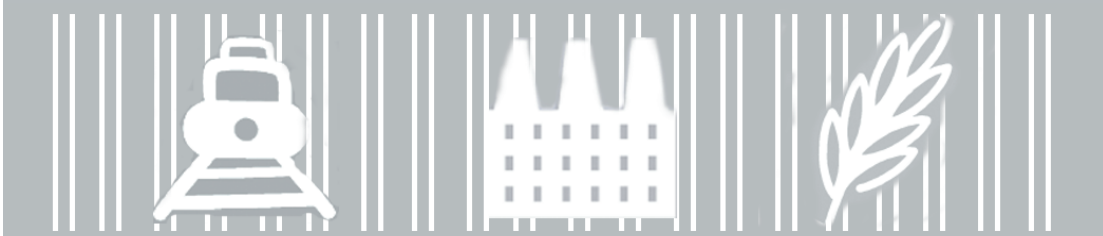

**FREIGHT COALITION**



**INSTITUTE FOR TRADE AND  
TRANSPORTATION STUDIES**