

MID-AMERICA



FREIGHT COALITION

**2012
ANNUAL MEETING**



**APRIL 18-20, 2012
HILTON MINNEAPOLIS HOTEL
MINNEAPOLIS, MINNESOTA**



The Mid-America Freight Coalition (MAFC) is a regional organization that cooperates in the planning, operation, preservation, and improvement of transportation infrastructure in the Midwest. The ten states of the AASHTO Mid-America Association of State Transportation Officials (MAASTO) share key interstate corridors, inland waterways, and the Great Lakes. The MAFC is funded by the National Center for Freight & Infrastructure Research & Education and the DOTs of the ten member states.

MID-AMERICA FREIGHT COALITION

2012 ANNUAL MEETING

TABLE OF CONTENTS

HILTON MINNEAPOLIS HOTEL	2
SCHEDULE AT-A-GLANCE	3
SPONSORS	4
SPEAKER BIOGRAPHIES	5
WEDNESDAY, APRIL 18	11
THURSDAY, APRIL 19	22
FRIDAY, APRIL 20	28

MID-AMERICA FREIGHT COALITION

2012 ANNUAL MEETING

HILTON MINNEAPOLIS HOTEL

THIRD FLOOR

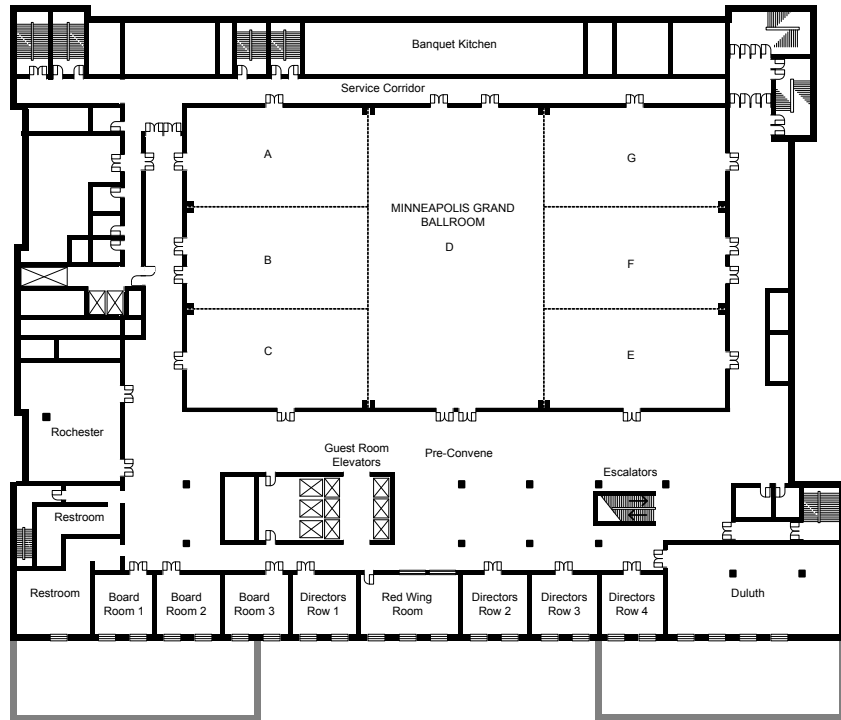

SECOND FLOOR

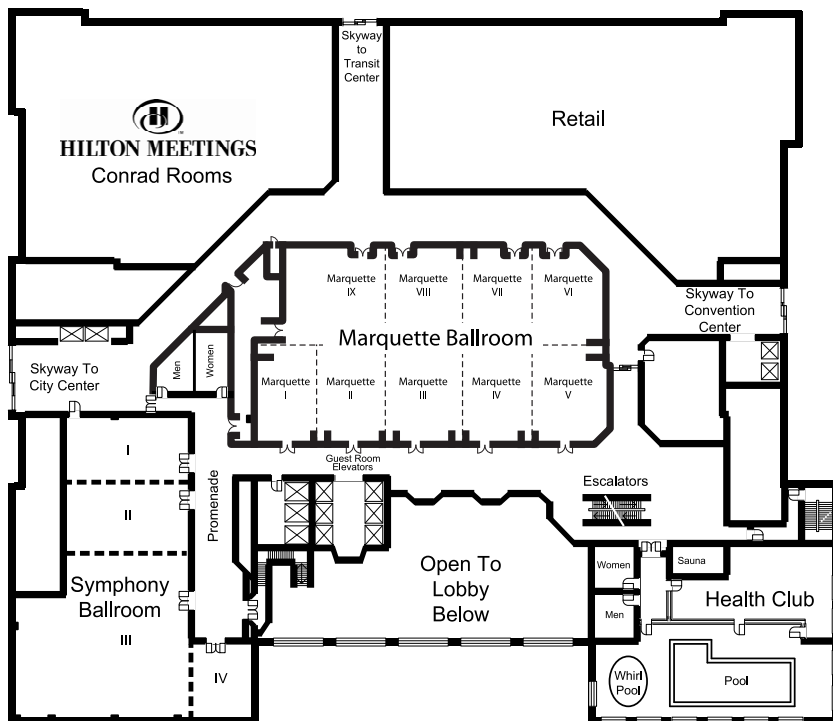

MID-AMERICA FREIGHT COALITION

2012 ANNUAL MEETING

SCHEDULE AT-A-GLANCE

Wednesday, April 18

7:00-8:00AM	SYMPHONY PROMENADE	BREAKFAST
8:00-8:15AM	SYMPHONY I-II	WELCOME & INTRODUCTIONS
8:15-8:45AM	SYMPHONY I-II	PERSPECTIVE ON TRANSPORTATION
8:45-9:00AM	SYMPHONY I-II	QUESTION & ANSWER
9:00-9:30AM	SYMPHONY I-II	FREIGHT PERSPECTIVE: MINNESOTA PRIVATE SECTOR
9:30-9:45AM	SYMPHONY I-II	QUESTION & ANSWER
9:45-10:00AM	SYMPHONY I-II	MAFC REGIONAL FREIGHT STUDY UPDATE
10:00-10:15AM		BREAK
10:15AM-12:00PM	SYMPHONY I-II	PANEL DISCUSSION: PRIVATE SECTOR FREIGHT PERSPECTIVES & FREIGHT ADVISORY TEAMS
12:00-1:00PM	SYMPHONY I-II	LUNCHEON PLENARY SESSION
1:00-1:15PM		BREAK
1:15-2:30PM		BREAKOUT SESSIONS (CONCURRENT)
	DULUTH	<i>Using Cost-Benefit Analysis to Document Freight Project Benefits</i>
	ROCHESTER	<i>Best Practices for Workforce Transition and Succession Planning for Freight Professionals</i>
2:30-2:45PM		BREAK
2:45-4:00PM	SYMPHONY I-II	PANEL DISCUSSION: FREIGHT RESEARCH AND NCFRP
4:00-5:00PM	SYMPHONY I-II	SUPPLY CHAINS AND THE SERVICE ECONOMY
5:30-7:00PM	ROCHESTER	ROUNDTABLE RECEPTION: OVERSIZE/OVERWEIGHT BEST PRACTICES: PERMITTING, DESIGN, AND CROSS-STATE COORDINATION

Thursday, April 19

7:00-8:00AM	SYMPHONY PROMENADE	BREAKFAST
8:00AM-1:00PM	OFF SITE	MINNESOTA TRANSPORTATION TOURS & BOX LUNCH
1:00-1:30PM	SYMPHONY I-II	INTRODUCTION OF MFAC PARTICIPANTS & COMBINED MEETING FORMAT
1:30-2:30PM	SYMPHONY I-II	UPDATE ON AUTHORIZATION AND FREIGHT COMPONENTS
2:30-2:45PM		BREAK
2:45-3:45PM	SYMPHONY I-II	MAFC MODAL ISSUES: RAIL AND AVIATION
3:45-4:45PM	SYMPHONY I-II	MAFC MODAL ISSUES: ROADS AND MULTIMODAL
4:45-5:00PM	SYMPHONY I-II	AFTERNOON WRAP-UP
5:30-7:00PM	ROCHESTER	RECEPTION

Friday, April 20

7:00-8:00AM	SYMPHONY PROMENADE	BREAKFAST
8:00-10:30AM	SYMPHONY I-II	MAFC BUSINESS MEETING <i>Regional Freight Study</i> <i>Research and Development Ideas</i> <i>MAFC Pooled Fund Process</i>
10:30AM		ADJOURN

MID-AMERICA FREIGHT COALITION

2012 ANNUAL MEETING

The Mid-America Freight Coalition 2012 Annual Meeting was planned and organized by the following people:

- Ernie Perry, University of Wisconsin-Madison (co-chair)
- John Tompkins, Minnesota Department of Transportation (co-chair)
- Teresa Adams, University of Wisconsin-Madison
- Cheryl Ball, Missouri Department of Transportation
- Bill Gardner, Minnesota Department of Transportation
- Walt Raith, East Central Wisconsin Regional Planning Commission

SPONSORS

The Mid-America Freight Coalition 2012 Annual Meeting was sponsored by the National Center for Freight and Infrastructure Research and Education (CFIRE), the Minnesota Department of Transportation (Mn/DOT), the Center for Transportation Studies (CTS), and the ten states of the Mid-America Freight Coalition.



CENTER FOR
TRANSPORTATION STUDIES



Tours of local freight facilities held on April 19, 2012 are supported by CDM Smith.



MID-AMERICA FREIGHT COALITION

2012 ANNUAL MEETING

SPEAKER BIOGRAPHIES

TERESA ADAMS

University of Wisconsin-Madison

Teresa Adams is Professor of Transportation Engineering and City Planning in the Department of Civil and Environmental Engineering at the University of Wisconsin–Madison, as well as director of the National Center for Freight and Infrastructure Research and Education and the Midwest Regional University Transportation Center. She is also principal investigator for the Mid-America Freight Coalition. Adams is a member of the board of directors for the American Road and Transportation Builders Association, Research and Education Division, the American Transportation Research Institute's Research Advisory Committee, and a member of the Committee on Intermodal Freight Transport for the Transportation Research Board. She is also chair of the Transportation Management and Policy graduate certificate program and a faculty affiliate of the Gaylord Nelson Institute for Environmental Studies. Adams holds a PhD and MS in civil engineering from Carnegie Mellon University and a BS in civil engineering from the University of Pittsburgh.

RANDY BERGER

FedEx Worldwide Services

Randy Berger is Managing Director, Healthcare Solutions at FedEx Corporate Services. Prior to joining FedEx, he developed information management systems for the banking and financial services industry. Berger currently leads a team of industry professionals with global account management responsibilities in the life sciences industry segment at FedEx. He is a member of the American Production Inventory Control Society and the Council of Supply Chain Management Professionals. Berger holds undergraduate degrees in computer science from Stark State College and business management from Malone University. Additionally, he has certification in demand flow technology from JCIT Institute of Technology.

MARK BERNDT

CDM Smith

Mark Berndt is an Associate with CDM Smith and is the discipline leader for Freight Planning. He has more than 30 years of professional experience related to freight planning, truck policy and economic development, including 15 years at the Minnesota Department of Transportation. Before departing Mn/DOT Berndt helped establish the Minnesota Freight Advisory Committee and served as MFAC's first administrator. Since joining the consulting business in 2001, he has managed urban, regional, and statewide multimodal freight planning efforts, truck policy studies, and been an instructor for an FHWA workshop entitled *Engaging the Private Sector*. He is the co-author of an FHWA guidebook on the same topic and is also a principal author of *Understanding Urban Goods Movement*, recently published by the Transportation Research Board. Berndt is currently the secretary of the TRB Agricultural Transportation Committee and is past chair of the Motor Vehicle Size and Weight Committee. He has also served on several other TRB freight committees and research project panels.

KEITH BUCKLEW

Indiana Department of Transportation

Keith Bucklew joined the Indiana Department of Transportation as Director of Freight Mobility in November 2006. Bucklew developed the Indiana Multimodal Freight and Mobility Plan and is managing the I-70 Dedicated Truck Lanes Feasibility Study. Prior to coming to INDOT, Bucklew worked in the motor carrier and logistics industries for 23 years. Bucklew is a graduate of Indiana University with a BS in business management and marketing and holds a MBA from the University of Wisconsin-Madison. He served 30 years in the US Army, active duty and reserves, retired as a Colonel, and is a graduate of US Army War College. He is an adjunct faculty of transportation, logistics, and supply chain management for IVY Tech Community College.

MID-AMERICA FREIGHT COALITION

2012 ANNUAL MEETING

SPEAKER BIOGRAPHIES, CONTINUED

DARRYL FIELDS

Mid-America Regional Council

Darryl Fields is a Senior Transportation Planner with the Mid-America Regional Council. He has more than 30 years public and private experience in program management, transportation revenue forecasting and planning, Intelligent Transportation Systems (ITS), traffic/congestion management, and freight transportation operation. Currently his work involves initiatives related to the transportation corridor and freight study project management, and managing the federal procurement process with MARC-related projects. Fields also participates in regional transportation planning activities that account for nearly \$2 billion of regional transportation investments. He also has more than 15 years experience with the day-to-day operation, sales, and dispatch of several national freight transportation trucking companies such as Yellow Freight, Roadway Express, Consolidated Freightways, and PIE Nationwide. Fields holds a MBA and degrees in business and psychology.

BILL GARDNER

Minnesota Department of Transportation

Bill Gardner is Director of Mn/DOT's Office of Freight and Commercial Vehicle Operations, where he is responsible for the department's freight, rail, waterway, and CVO programs and activities. Gardner has been with Mn/DOT for 12 years and has 32 years of multi-modal transportation planning, operations, and management experience. He has worked for local, regional, and state transportation agencies as well consulting and technology firms in Minnesota, Wisconsin, and Massachusetts. Gardner holds degrees from the University of Wisconsin and the University of North Carolina.

BILL GOINS

FedEx Worldwide Services

Bill Goins is Worldwide Account Manager for FedEx Worldwide Services, where he provides strategic planning, account management, and supply chain leadership to several major corporations headquartered in Minnesota. His transportation and logistics experience includes more than 20 years of active duty and reserve assignments in the US Navy Supply Corps; he retired as a Navy Commander. Goins has been an adjunct professor at the Carlson School of Management at the University of Minnesota, a ten-year member of the Minnesota Freight Advisory Council, and serves on the Supply Chain Advisory Board at CSOM and on the Board of Advisors for the Center for Transportation Studies. Goins holds a bachelor's degree in economics from the University of Minnesota and a MBA in transportation and logistics from Golden Gate University.

RON HAVE

Freightmasters, Inc.

Ron Have is President of Freightmasters, Inc. and Chairman of the Minnesota Freight Advisory Committee. He is an active member of the American Trucking Association, Minnesota Trucking Association, Minnesota Freight Advisory Council, Twin Cities Air Cargo Association, Distributors and Consolidators of America, Midwest Import Trade Association, and various state and national chambers of commerce. He presently serves on the Board of Regents of Luther College in Decorah Iowa, as President of the VEAP food shelf for the southern Twin Cities, as a board member for Hope for the City, a board member on the Metropolitan Council Transportation Advisory Board, and a board member at the University of Minnesota Center for Transportation Studies. Have holds a BS in business administration from the University of Minnesota.

MID-AMERICA FREIGHT COALITION

2012 ANNUAL MEETING

SPEAKER BIOGRAPHIES, CONTINUED

DANIEL HAAKE

Mid-Ohio Regional Planning Commission

Daniel Haake is a Principal Planner with the Mid-Ohio Regional Planning Commission (MORPC) in Columbus, Ohio. At MORPC, Haake led an effort to alleviate a critical freight bottleneck that threatened a major economic generator in Ohio. In addition to this work in freight and logistics, Haake served as project manager for the first evacuation plan in the United States that focused primarily on those with mobility needs. Haake holds both elected and appointed leadership positions with national transportation organizations. Most recently, he was elected the American Planning Association-Transportation Division's Vice-Chair for Policy. Haake is a certified planner by the American Institute of Certified Planners (AICP). Haake holds a BA in political science and a master's in urban and regional planning from Ball State University, a certificate in public management from Indiana University, and an MS in logistics and supply chain management from Wright State University.

SCOTT JANOWIAK

University of Wisconsin-Madison

Scott Janowiak is a project assistant at the National Center for Freight and Infrastructure Research and Education at the University of Wisconsin-Madison, where he's currently researching air cargo and helping organize the National Transportation Workforce Summit. His previous efforts have included highway maintenance quality assurance issues. Janowiak is wrapping up a master's degree in urban and regional planning with a certificate in Transportation Management and Policy. He also holds a BA in sociology and anthropology with a certificate in African studies from UW-Madison.

AARON JORGENSEN

Medtronic

Aaron Jorgensen is the Senior Director of Medtronic's Global Supply Chain Logistics and International Trade Compliance. Over the last 12 years he has developed an international transportation and logistics infrastructure to deliver Medtronic's mission of eliminating pain, restoring health, and extending life across the globe.

JACQUELINE KAMIN

Wisconsin Department of Transportation

Jacqueline Kamin is a program and policy analyst for Wisconsin DOT's Research Unit, managing the pooled fund research program for WisDOT. Additionally, she works with partners such as TRB and NCHRP on other national research opportunities and department initiatives. She entered the transportation industry after leaving non-profit work. Kamin holds a BA in psychology from the University of Iowa.

SHELLEY LATHAM

Perkins Specialized Transportation Contracting

Shelley Latham is a Project Manager at Perkins Specialized Transportation Contracting. She orchestrates the moving of loads 200 feet long, 20 feet wide, 17 feet high, and over half-million pounds. She has been working in various positions at Perkins for more than 35 years.

MARK LOCKER

Ohio Department of Transportation

Mark Locker currently acts as the Manager for Maritime & Freight Mobility at the Ohio Department of Transportation. His duties include development of a strategic maritime and freight mobility plan for Ohio. He currently oversees a portfolio of \$110 million in maritime projects including ARRA Stimulus Projects on the Great Lakes and the Ohio River. During his

MID-AMERICA FREIGHT COALITION

2012 ANNUAL MEETING

SPEAKER BIOGRAPHIES, CONTINUED

26 years of service to ODOT, he has worked in the areas of construction, design, research, environmental services, multi-modal planning, and maritime and freight mobility. Locker was recently appointed by US DOT Secretary Ray LaHood to serve as an advisor on the Marine Transportation System National Advisory Council (MTSNAC). Locker holds degrees in civil engineering from Sinclair College and engineering and city and regional planning with minors in economics and government administration from The Ohio State University.

MARTIN LOKEN

Canadian Consulate, Minneapolis

Martin Loken is Canada's senior diplomatic representative responsible for the Upper Midwest states of Iowa, Minnesota, Nebraska, North Dakota, and South Dakota. As Consul General he leads a team of Minneapolis-based professionals working to deepen cross-border commercial ties, to engage decision-makers and citizens on a range of issues of interest to both countries and to help Canadians living and travelling in the region. A member of Canada's Foreign Service since 1990, he has represented Canada overseas in Prague and Geneva, and has held several positions in Ottawa, including as a senior trade negotiator. He holds degrees in systems design engineering and arts from the University of Waterloo, Waterloo, Ontario.

PETER LYNCH

Wisconsin Traffic Operations and Safety Lab & Wisconsin Department of Transportation

Peter Lynch is the Freight Operations Program Manager for the Traffic Operations and Safety (TOPS) Lab at the University of Wisconsin-Madison and works for WisDOT's Bureau of Highway Maintenance-Freight Section through a strategic partnership between WisDOT and the TOPS Lab. Lynch provides routing and operations support for specialized transport (oversize/overweight) vehicles, works with infrastructure designers to ensure seamless mobility for freight, and works to develop a OSOW freight network. Lynch holds a BS in urban planning from Michigan State University.

JOHN MADDOX

Kansas Department of Transportation

John Maddox is the Freight and Rail Program Manager at the Kansas Department of Transportation. John's responsibilities include administering state-funded rail rehabilitation programs, applying for federal grant programs, monitoring state, regional, and national rail and motor carrier issues and legislation, providing oversight for various studies, data analyses, and passenger rail activities and issues. Maddox has been with KDOT for 13 years and has served as Freight and Rail Program Manager for the past 4 years.

ALEX MARACH

University of Wisconsin-Madison

Alex Marach is a graduate project assistant at the National Center for Freight and Infrastructure Research and Education at the University of Wisconsin-Madison, where he is working on a guide to benefit-cost analysis for US DOT TIGER grants. Alex is a second-year master's candidate at the La Follette School of Public Affairs. Marach holds a BA in economics and politics and government from Ripon College.

RICHARD MURPHY

Murphy Warehouse Company

Richard T. Murphy, Jr. is President and CEO of Murphy Warehouse Company, a supply chain logistics services organization that provides distribution, transportation, warehousing, and value-added services for domestic and international clients. He is a past chair of the global Council of Supply Chain Management Professionals (CSCMP), a member of the University of Minnesota Carlson School of Management's Supply Chain & Operations Advisory Board, the College of Design

MID-AMERICA FREIGHT COALITION

2012 ANNUAL MEETING

SPEAKER BIOGRAPHIES, CONTINUED

Board, and a past executive committee chair of the Center for Transportation Studies (CTS), and board member of the International Warehouse Logistics Association. Murphy is also a licensed landscape architect, a past president of the American Society of Landscape Architects - MN Chapter, and this winter is teaching his twenty-fifth year in the College of Design at the University of Minnesota.

ERNIE PERRY

University of Wisconsin-Madison

Ernie Perry is the Program Administrator and Facilitator of the Mid-America Freight Coalition. Before joining the National Center for Freight and Infrastructure Research and Education, Perry was the Administrator of Freight Development at the Missouri Department of Transportation. During his seventeen-year tenure at MoDOT, he also served as research director, organizational results administrator, senior environmental specialist, and socioeconomic specialist. Perry has worked closely with freight leadership at AASHTO, FHWA, and MARAD, served on three NCFRP panels, and participated in the Scan of European Union Freight Corridors. Perry holds a BS in animal science, an MS in rural sociology, and a PhD in rural sociology from the University of Missouri-Columbia.

MARC ANDRÉ ROY

CPCS Transcom Limited

Marc-André Roy is CPCS's Vice President responsible for North America and a Principal with the company. He has led transportation-sector management consulting assignments for public and private sector clients in North America, Asia, South America, the Middle East, and Africa. He was the top MBA graduate from the Schulich School of Business in 2004 and is on the boards of the Canadian Transportation Research Forum and the Chartered Institute of Transport and Logistics in North America.

CHRIS SMITH

American Association of State Highway and Transportation Officials

Chris Smith is the Intermodal Policy and Program Manager in the Policy & Governmental Affairs Department of AASHTO. He staffs standing policy committees related to the movement of freight on highways, railroads, and maritime systems with the goal of one-day realizing an efficient national freight transportation network. Prior to joining AASHTO in 2008, he was Vice President of Public Policy for the Greater Tampa Chamber of Commerce. Smith holds BA degrees and a masters of public administration and policy from Florida State University.

TOM SOREL

Minnesota Department of Transportation

Tom Sorel has been the Commissioner of the Minnesota Department of Transportation since April 2008. He leads an agency of 5,000 people who are committed as servant leaders to uphold public needs and collaboration with internal and external partners to create a safe, efficient, and sustainable transportation system for the future. Prior to becoming Commissioner, Sorel worked for 30 years in numerous positions around the country with the US Department of Transportation, Federal Highway Administration. He served as the Division Administrator for the FHWA Minnesota Division Office, the Major Projects Team Leader in Washington, DC, the US DOT Intermodal Liaison for the 2002 Winter Olympic Games in Salt Lake City, and the Director of Planning and Program Development in FHWA's Regional Office in Albany, NY. At AASHTO, he currently serves as the President of the Mid-America Association of State Transportation Officials and the Executive Committee. He chairs the Standing Committee on Highway Traffic Safety and also serves on the Standing Committee on Performance Measures. Sorel has a MBA from Thomas College in Maine, a bachelor's degree in civil engineering from the University of Buffalo, New York, a certificate in conflict management from the Cornell School of Industrial and Labor Relations, and a certificate in project management from George Washington University. He has

MID-AMERICA FREIGHT COALITION

2012 ANNUAL MEETING

SPEAKER BIOGRAPHIES, CONTINUED

also completed the Wharton Transportation Executive Program and the Federal Executive Institute Leadership for a Democratic Society.

ED STROCKO

Federal Highway Administration

Ed Strocko is Manager of the Freight Performance Measures Program in the Federal Highway Administration's Office of Freight Management and Operations. He has served as FHWA's TIGER Program Coordinator and manages several large infrastructure programs including Projects of National and Regional Significance. Strocko focuses on freight performance measures, urban freight issues, freight policy, economics, and finance. Prior to joining FHWA, Strocko was the manager of multimodal studies for the Maryland Department of Transportation. He also worked as a land use and community planner for a number of jurisdictions.

ERNIE WITTWER

Wittwer Consulting

Ernie Wittwer has been in the transportation industry since 1976 when he joined the Wisconsin Department of Transportation. Over his 24 years with the department, he held a number of senior positions in management, finance, policy, planning, and programming. In 2000, he accepted the position of director of the Midwest Regional University Transportation Center. This position, which he held for five years, began a relationship with the university that continues to the present. As director, researcher, and consultant, Wittwer has taken part in a number of efforts that led to the Mid-America Regional Freight Coalition. In semi-retirement, he continues to work on projects with the Wisconsin Transportation Center.



listen. think. deliver.®



Water
Environment
Transportation
Energy
Facilities



**CDM
Smith**
cdmsmith.com

St. Paul, Minnesota – 651.772.1313

THE 2012 MAFC ANNUAL MEETING

IS SPONSORED BY

MID-AMERICA



FREIGHT COALITION



**CENTER FOR
TRANSPORTATION STUDIES**



**CORRIDORS
COLLABORATION
CONNECTIONS**